

Call Toll-Free: 1-800 Van Mark Email: sales@van-mark.com

**Save Time! Save Money!**

All 3000 Series Parts Numbers are Complete  
"Ready to Use" Assemblies.





Ref	Description		Model B850 Contr B851 HD P/N	Model B1050 Contr B1051 HD P/N	Model B1250 Contr B1251 HD P/N
1	Slide Bar & Wedge Assm	Cont	3540	3541	3542
2	Slide Bar & Wedge Assm	HD	3547	3548	3549
3	L Bar w/SS Edge Strip	Cont	3554	3555	3556
4	L Bar w/SS Edge Strip	HD	3561	3562	3563
5	Hinge, Front w/Red Vinyl Strip		3568	3569	3570
6	Hinge, Fixed Rear	Contr	4038	4039	4040
7	Hinge, Fixed Rear	HD	4140	4141	4142
8	Rail, Base	Cont	4045	4046	4047
9	Rail, Base	HD	4147	4148	4149
10	Strip, Stainless Steel Edge*		4182	4183	4184
11	Pin, Stainless Steel Hinge		4062	4063	4064

\*Can ship via UPS in 2 pcs.

**Parts For All Models**

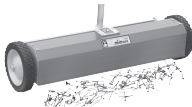
Ref	Part Name	P/N
12	Strips, Red Vinyl Wear (2 ea)	3627
13-14	Handle, Bending w/Brackets	3536
14	Brackets, Bending Handle (2 ea)	3579
15-16	Wedges & Wedge Block Assm	3525
16	Wedge Block w/Clevis Pin	3526
17-18	Block & Yoke, Bottom Assembly	3527
19	Springs, Round 1/8" x 9" (4 ea)	3530
20	Casting, C Clamp 7 1/2" High	3523
21-22	Handles, Locking w/Red Grip	3524
23	Handles, Carrying (2 ea)	3572
24-27	Material Stop Assembly (2 ea)	3507
32	Screws, Alum. Adjusting (14 ea)	3531

**Optional Accessories**

NailHawg™	Steel Folding Legs 3000	Wheel Kit 3004	UniStand™ USA1
			
Gets nails from job site (shown with partial handle)	Heavy-Duty steel legs (includes hardware)	Fits All Van Mark Brakes Attaches to one end of Brake Base Rails	Easily maneuvers Van Mark tools over terrains

**Tune-Up Kits**

Contractor Model P/N 3575  
Commercial Model P/N 3505

Ref	Description
12	Strip, Red Vinyl Wear
15-16	Wedges & Wedge Block Assembly
19	Springs, Round 1/8" x 9"
21-22	Handle, Locking w/Red Grip
32	Screws, Aluminum Adjusting 1/2" x 5/16"
	Screw & Fastener Package, Misc

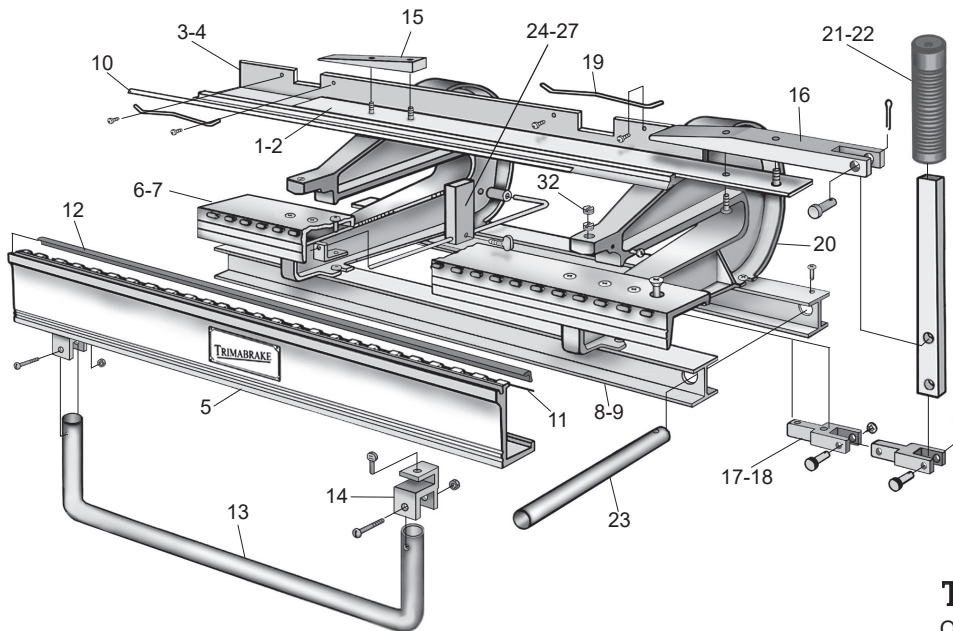

\*Newer Trim-A-Brake I™ models, built from July 1985-May 2000 need vinyl strip part #3658 Check your Serial Number before placing order.

**Trim-A-Brake I™**

Orders must include model and serial no. in order to guarantee correct parts are shipped.

**VAN MARK PRODUCTS CORPORATION**

24145 Industrial Park Drive, Farmington Hills, MI 48335-2864 Michigan 1-248-478-1200

Call Free 1-800-VAN-MARK (1-800-826-6275) Fax Free! 1-888-VAN-MARK (1-888-826-6275)

Web Site: www.van-mark.com

E-mail: sales@van-mark.com